

Section II.

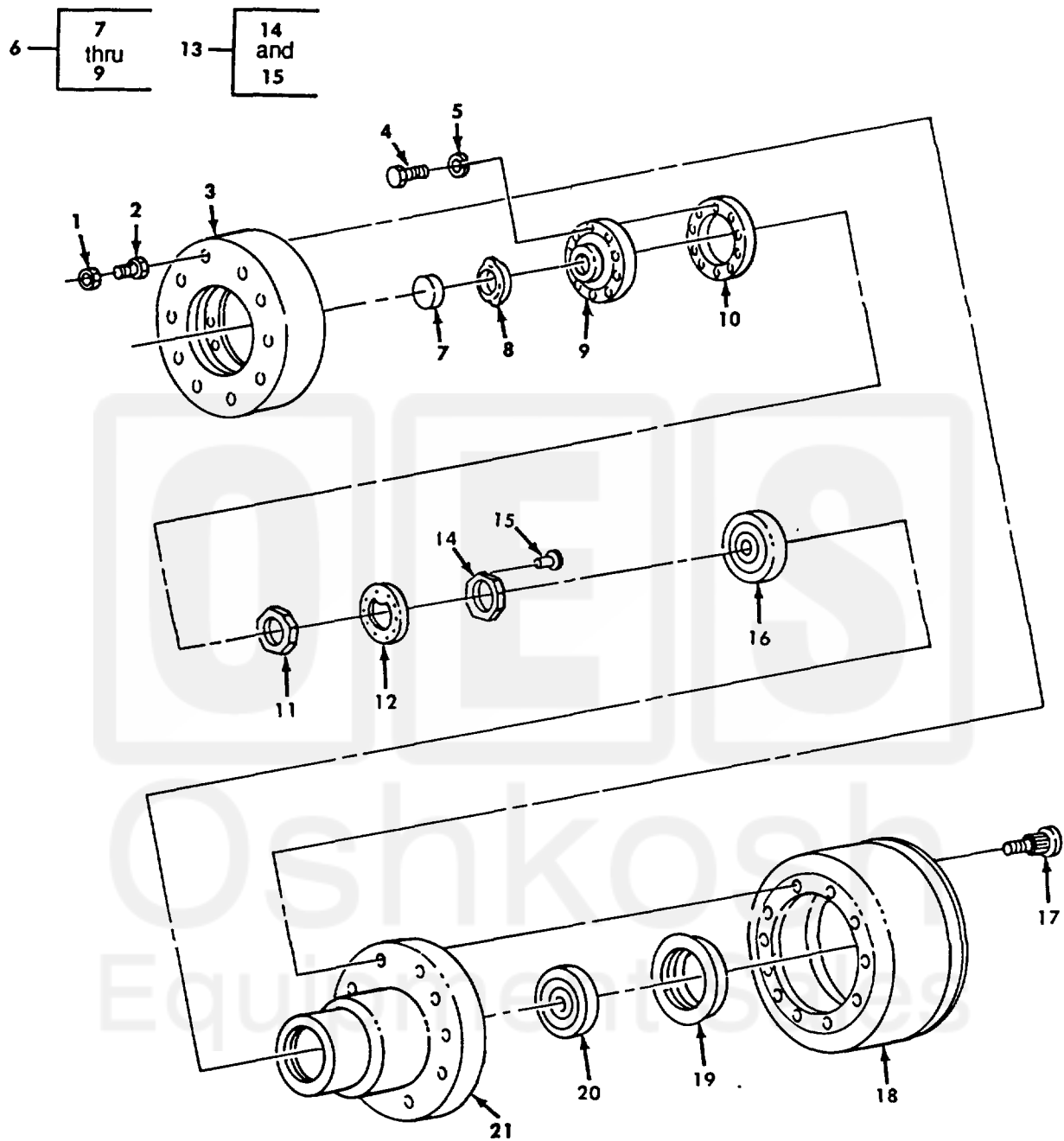

Figure 293. Front Wheel Hub and Drum Assembly (M939, M939A1).

| SECTION II | | | | | TM 9-2320-272-24P-1 | |
|--|----------|---------------|-------|-------------|--|-----|
| (1) | (2) | (3) | (4) | (5) | (6) | (7) |
| ITEM NO | SMR CODE | NSN | CAGEC | PART NUMBER | DESCRIPTION AND USABLE ON CODES (UOC) | QTY |
| GROUP 1311 WHEEL ASSEMBLY | | | | | | |
| FIG. 293 FRONT WHEEL HUB AND DRUM ASSEMBLY (M939 , M939A1) | | | | | | |
| 1 | PAOZZ | 5310013753107 | 24614 | 3A7313 | NUT, PLAIN, SINGLE BA WHEEL STUD, R.H..... UOC:DAA, DAB, DAC, DAD, DAE, DAF, DAG, DAH, DAJ, DAK, DAL, DAW, DAX, V12 , V13, V14, V15, V16, V17, V18, V19, V20, V21 , V22, V24, V25 | 10 |
| 1 | PAOZZ | 5310002737771 | 78500 | 1199G111 | NUT, PLAIN, SINGLE BA WHEEL STUD, L.H..... UOC: DAA, DAB, DAC, DAD, DAE, DAF, DAG, DAH, DAJ, DAK, DAL, DAW, DAX, V12, V13 , V14, V15, V16, V17, V18, V19, V20, V21, V22, V24, V25 | 10 |
| 1 | PAOZZ | 5310012298029 | 96906 | MS51983-8 | NUT, PLAIN, SINGLE BA WHEEL STUD, R.H. 10 UOC :V39 | |
| 1 | PAOZZ | 5310012705463 | 58536 | A-A-52427 | NUT, PLAIN, SINGLE BA WHEEL STUD, L.H..... UOC :V39 | 10 |
| 2 | PAOZZ | 2530003591162 | 78500 | 1199J114C | NUT, CAP, DUAL WHEEL, R.H | 10 |
| 2 | PAOZZ | 2530006931029 | 52304 | 10709 | NUT, CAP, DUAL WHEEL, L.M | 10 |
| 3 | PAOZZ | 2530007411105 | 78500 | 3280-B-1978 | ADAPTER, BRAKE DRUM | 2 |
| 4 | PAOZZ | 5306001829267 | 19207 | 10896726 | BOLT, MACHINE | 20 |
| 5 | PAOZZ | 5310000034094 | 01276 | 210104-8S | WASHER, LOCK | 20 |
| 6 | PAOZZ | 2520007346991 | 19207 | 7346991 | FLANGE, COMPANION, VE | 2 |
| 7 | PAOZZ | 5340007346992 | 19207 | 7346992 | .PLUG, EXPANSION..... UOC: DAA, DAB, DAC, DAD, DAE, DAF, DAG, DAH, DAJ, DAK, DAL, DAW, DAX, V12 , V13 , V14 , V15, V16, V17, V18, V19, V20, V21, V24, V25, V39 | 1 |
| 8 | PAOZZ | 5330002913273 | 96906 | MS29513-229 | .PACKING, PREFORMED | 1 |
| 9 | XAOZZ | | 19207 | 8758278 | .FLANGE ASSEMBLY, COMPANION, UN NHA..... P/N 7346991 19207 | 1 |
| 10 | PAOZZ | 5330013779775 | 14153 | 02764 | GASKET, NON-ASBESTOS | 2 |

| SECTION II | | | | | TM 9-2320-272-24P-1 | |
|------------|----------|---------------|-------|-------------|---|-----|
| (1) | (2) | (3) | (4) | (5) | (6) | (7) |
| ITEM NO | SMR CODE | NSN | CAGEC | PART NUMBER | DESCRIPTION AND USABLE ON CODES (UOC) | QTY |
| | | | | | UOC:DAA, DAB, DAC, DAD, DAE, DAF, DAG, DAH, DAJ, DAK, DAL, DAW, DAX, V12, V13, V14, V15, V16, V17, V18, V19, V20, V21, V22, V24, V25, V39 | |
| 11 | PAOZZ | 5310003532427 | 19207 | 7979263 | NUT, PLAIN, OCTAGON | 2 |
| | | | | | UOC: DAA, DAB, DAC, DAD, DAE, DAF, DAG, DAH, DAJ, DAK, DAL, DAW, DAX, V12, V13, V14, V15, V16, V17, V18, V19, V20, V21, V22, V24, V25, V39 | |
| 12 | PAOZZ | 5310007007089 | 19207 | 5139123 | WASHER, KEY, WHEEL BEARING LOCK | 2 |
| | | | | | UOC: DAA, DAB, DAC, DAD, DAE, DAF, DAG, DAH, DAJ, DAK, DAL, DAW, DAX, V12, V13, V14, V15, V16, V17, V18, V19, V20, V21, V22, V24, V25, V39 | |
| 13 | PAOZZ | 5310003740836 | 19207 | 7979308 | NUT, PLAIN, OCTAGON | 2 |
| | | | | | UOC: DAA, DAB, DAC, DAD, DAE, DAF, DAG, DAH, DAJ, DAK, DAL, DAW, DAX, V12, V13, V14, V15, V16, V17, V18, V19, V20, V21, V22, V24, V25, V39 | |
| 14 | XAOZZ | 5310011350049 | 19207 | 7979309 | .NUT, PLAIN, OCTAGON | 1 |
| | | | | | UOC: DAA, DAB, DAC, DAD, DAE, DAF, DAG, DAH, DAJ, DAK, DAL, DAW, DAX, V12, V13, V14, V15, V16, V17, V18, V19, V20, V21, V22, V24, V25, V39 | |
| 15 | PAOZZ | 5315010587268 | 19207 | 7979310 | .PIN, ADJUSTMENT, OUTER WHEEL..... | 1 |
| | | | | | BEARING NUT | |
| | | | | | UOC:DAA, DAB, DAC, DAD, DAE, DAF, DAG, DAH, DAJ, DAK, DAL, DAW, DAX, V12, V13, V14, V15, V16, V17, V18, V19, , 20, V21, V22, V24, V25, V39 | |
| 16 | PAOZZ | 3110001004223 | 96906 | MS19081-181 | BEARING, ROLLER, TAPE | 2 |
| | | | | | UOC: DAA, DAB, DAC, DAD, DAE, DAF, DAG, DAH, DAJ, DAK, DAL, DAW, DAX, V12, V13, V14, V15, V16, V17, V18, V19, , 20, V21, V22, V24, V25, V39 | |
| 17 | PAOZZ | 5307011424783 | 78500 | 20X-1529 | STUD, LEFT FRONT WHEEL | 10 |
| | | | | | UOC:V39 | |
| 17 | PAOZZ | 5307011424784 | 78500 | 20X-1528 | STUD, RIGHT FRONT WHEEL | 10 |
| | | | | | UOC:V39 | |
| 17 | PAOZZ | 5306012715842 | 78500 | 20X-1815-Z | STUD, LEFT FRONT WHEEL | 10 |
| | | | | | UOC: DAA, DAB, DAC, DAD, DAE, DAF, DAG, DAH, DAJ, DAK, DAL, DAW, DAX, V12, V13, V14, V15, V16, V17, V18, V19, V20, V221, V22, V2 2, V2 5 | |
| 17 | PAOZZ | 5306012715843 | 78500 | 20X-1816-Z | BOLT, RIBBED, SHOULDE, RIGHT FRONT | 10 |
| | | | | | WHEEL | |
| | | | | | UOC: DAA, DAB, DAC, DAD, DAE, DAF, DAG, DAH, DAJ, DAK, DAL, DAW, DAX, V12, V13, V14, V15, V16, V17, V18, V19, V20, V21, V22, V24, V25 | |
| 18 | PAOZZ | 2530011346570 | 78500 | 3219-C-4345 | BRAKE DRUM | 2 |
| | | | | | UOC: DAA, DAB, DAC, DAD, DAE, DAF, DAG, DAH, DAJ, DAK, DAL, DAW, DAX, V12, V13, V14, V15, V16, V17, V18, V9, V20, V21, V22, V24, V25, V39 | |

| SECTION II | | | | | TM 9-2320-272-24P-1 | |
|------------|----------|---------------|-------|-------------|--|-----|
| (1) | (2) | (3) | (4) | (5) | (6) | (7) |
| ITEM NO | SMR CODE | NSN | CAGEC | PART NUMBER | DESCRIPTION AND USABLE ON CODES (UOC) | QTY |
| 19 | PAOZZ | 533001448350 | 19207 | 12375801 | SEAL, PLAIN, ENCASED UOC:DAA, DAB, DAC, DAD, DAE, DAF, DAG, DAH, DAJ, DAK, DAL, DAW, DAX, V12, V13, V14, V15, V16, V17, V18, V19, V20, V21, V22, V24, V25, V39..... | 2 |
| 20 | PAOZZ | 3110006898250 | 96906 | MS19081-182 | BEARING, ROLLER, TAPE, INNER UOC:DAA, DAB, DAC, DAD, DAE, DAF, DAG, DAH, DAJ, DAK, DAL, DAW, DAX, V12, V13, V14, V15, V16, V17, V18, V19, V20, V21, V22, V24, V25, V39..... | 2 |
| 21 | PAOZZ | 3040011391611 | 78500 | A333-T-2334 | HUB, FRONT WHEEL UOC:DAA, DAB, DAC, DAD, DAE, DAF, DAG, DAH, DAJ, DAK, DAL, DAW, DAX, V12, V13, V14, V15, V16, V17, V18, V19, V20, V21, V22, V24, V25, V39..... | 2 |

